

āglō 236x89

SEG LIGHTBOX DISPLAY

Wellington

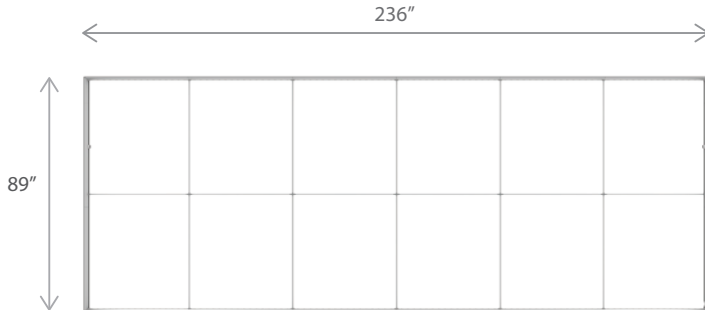

PRODUCT DESCRIPTION

Our āglō smart light box displays feature swift tool-free installation, durable light-weight frames, embedded LEDs, and exclusive One Planet recycled fabrics with impressive vivid graphics, all conveniently organized in a heavy-duty shipping case. **Wellington** boasts an impressive seamless presentation for a 20ft backlit exhibition.

Mix-and-match with other āglō panels, or combine with our I.COM or Impact!Pro displays, to create unique branded environments. TV mounts and counters complete an enhanced experience to really make your brand stand out.

KEY FEATURES

- Easy tool free assembly
- Lightweight portable construction
- Magnetic power links
- LED lights encapsulated in frame
- Heavy duty shipping case, molded foam inserts
- Single- or double-sided
- Vibrant graphics on recycled fabric

DISPLAY CONSTRUCTION

Aluminum frame with aluminum support poles

DIMENSIONS

Assembled Unit	236"w x 89"h x 4"d
Packed Case	46.5"w x 15"h x 12"d, 72 lbs (Qty. 2)
Shipping Box	47"w x 16"h x 13"d, 74 lbs (Qty. 2)
Graphic Size	236"w x 89"h

GRAPHIC MATERIAL

Graphic Print : Dye sublimated on One Planet, 100% recycled, backlit fabric	Bottles recycled 152
Blocker : One Planet light block recycled fabric	Bottles recycled 61

LED LIGHT SPECIFICATIONS

Power Requirements	384 W
CCT (Color Temp)	6000 K
Voltage Input	110 / 220V
Voltage Output	24V 11A 264W
Transformers Included	2

GRAPHIC FINISHING

Silicone sewn edges

WARRANTY

Limited Warranty Periods

- Frame : Lifetime
- Lights : 90 days
- Graphics : 30 days

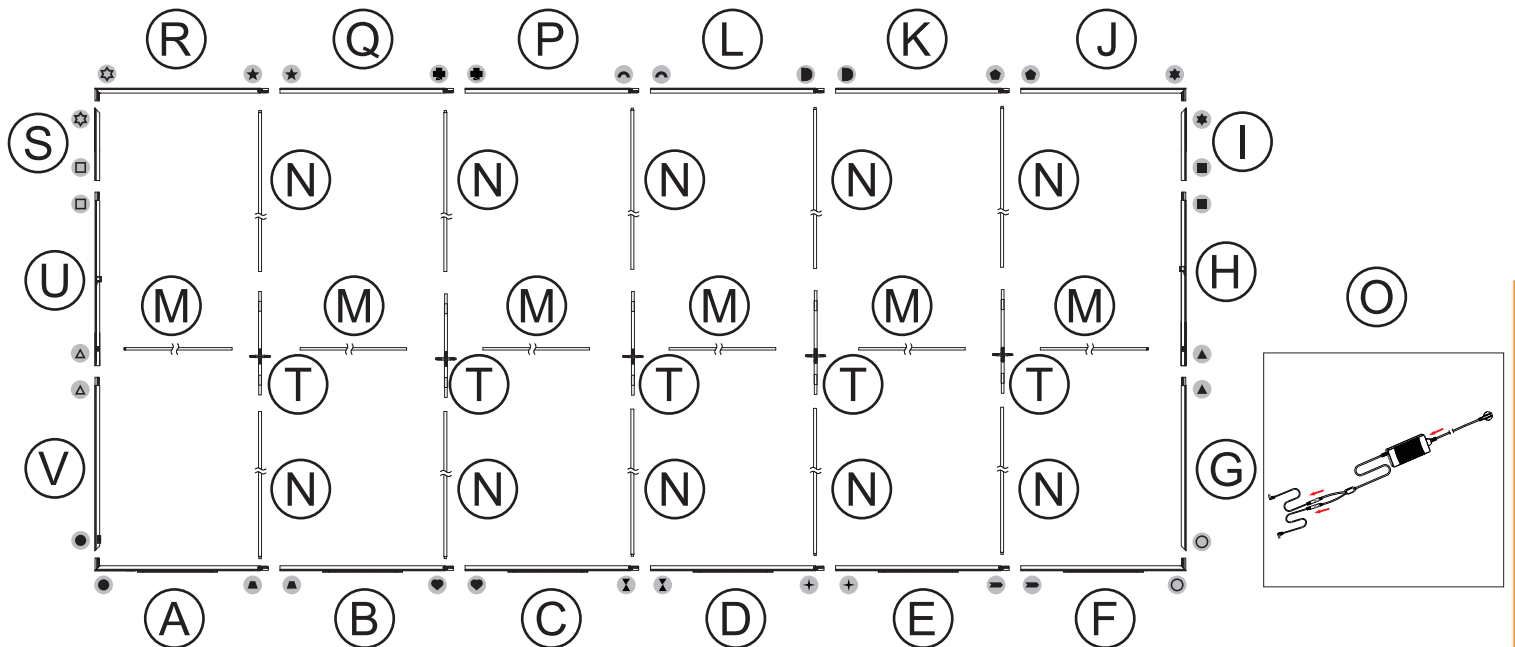
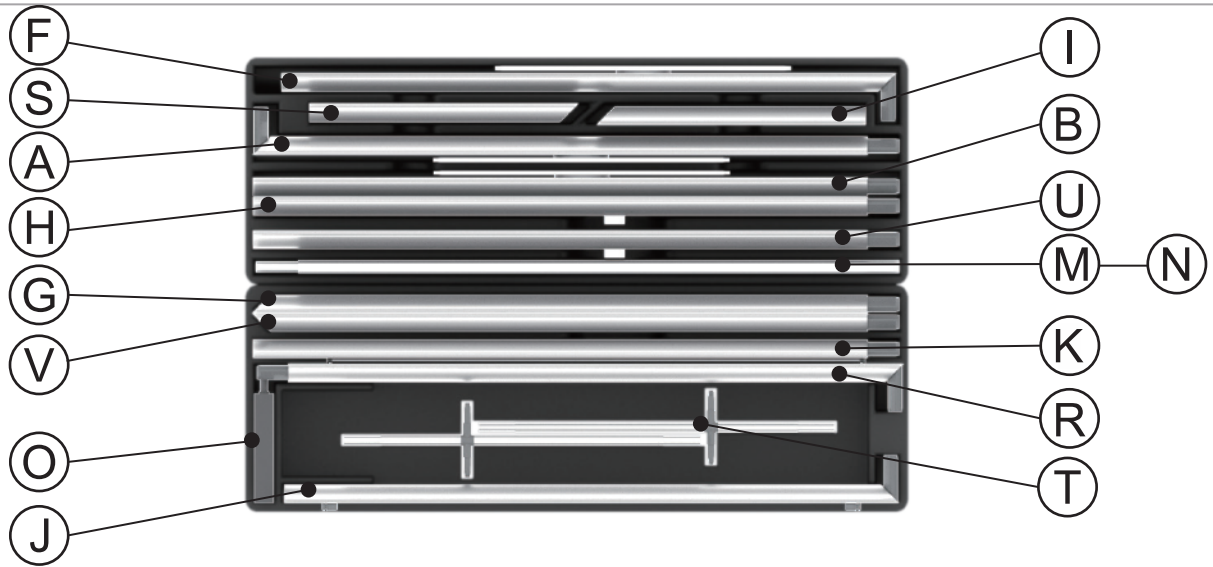

Assemble parts on the floor and stand-up unit when completed.

1

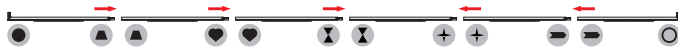
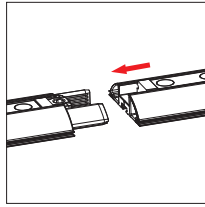

2

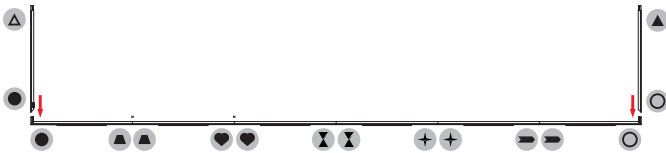
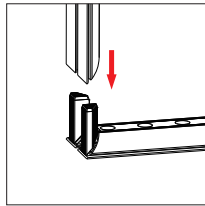

3

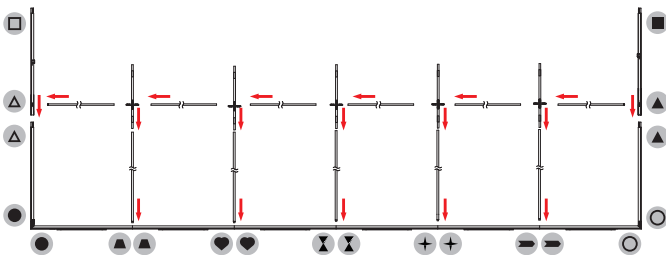
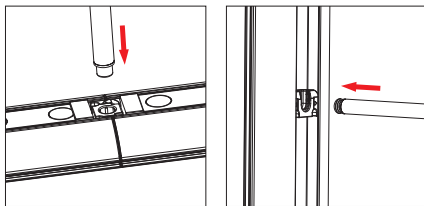

4

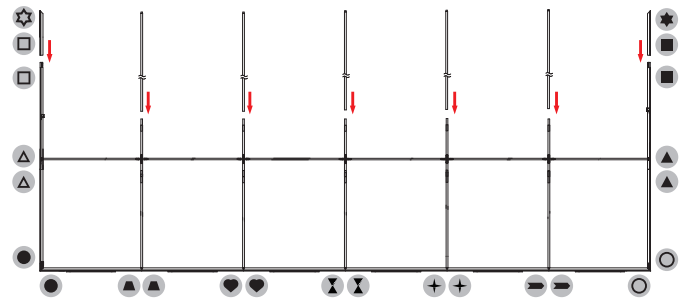
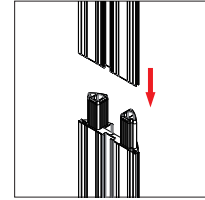

5

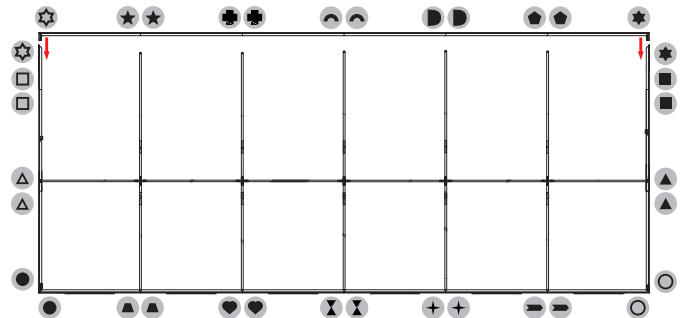
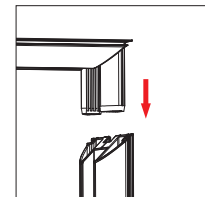

- 6 Push the silicone bead into each corner of the frame with your thumb.

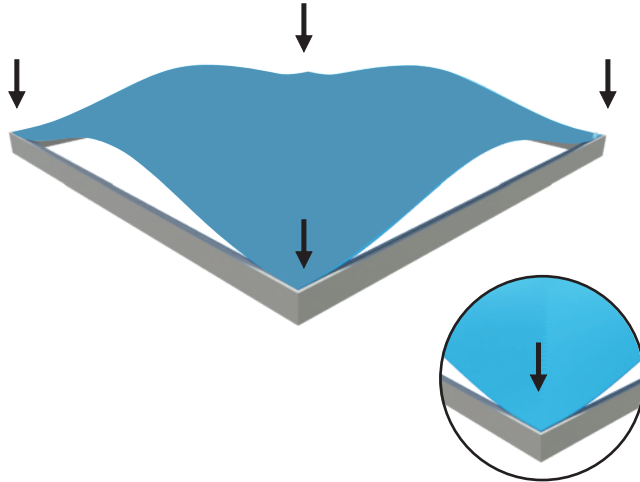

Push the silicone bead into the middle of the run and work your way around the perimeter of the frame until all beading is pushed in properly

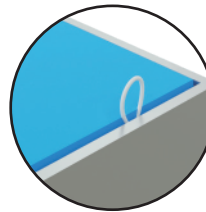
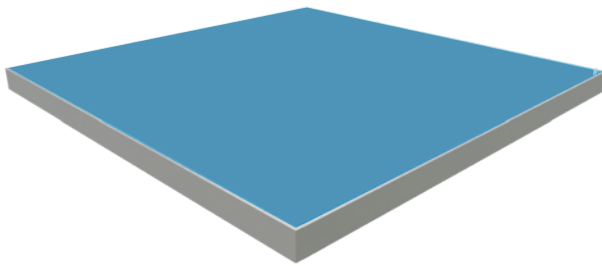
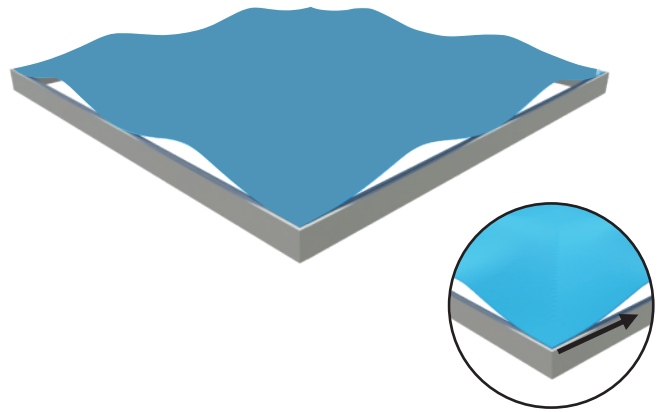

To Remove Graphic
Use the pull tab located on the graphic and gently pull the graphic from the frame, going around the perimeter

- 7

